



# County of Fresno

DEPARTMENT OF PUBLIC WORKS AND PLANNING  
STEVEN E. WHITE, DIRECTOR

## ***Architect's Supplemental Instructions***

---

**Date: October 28, 2024**

**Instruction Number: ASI B01**

**PROJECT:** DBH OLIVE AVE ROOF REPLACEMENT AND FAÇADE REPAIRS  
5555 E. OLIVE AVE, FRESNO, CA 93727  
Contract No.: 24-S-08

**ARCHITECT:** Barry Mast

**DESCRIPTION:**

1. REPLACE DETAIL K1/A-803 WITH DETAIL SHOWN ON PAGE 2 THIS ASI.
2. PROVIDE PLATFORM FRAMING PER THE FOLLOWING DETAILS AT ROOF-MOUNTED OUTDOOR UNITS AS INDICATED ON PROPOSED ROOF PLAN, DETAIL A2/A-202.1, KEYNOTE 14. REFER TO DETAIL A3/A-A802 SIM FOR ROOFING AND GALVANIZED SHEET METAL CAP.
  - a. DETAIL 1 – ODU 4 DIMENSIONS
  - b. DETAIL 2 – ODU CURB FRAMING PLAN
  - c. DETAIL 3 – ODU CURB MOUNTING DETAIL

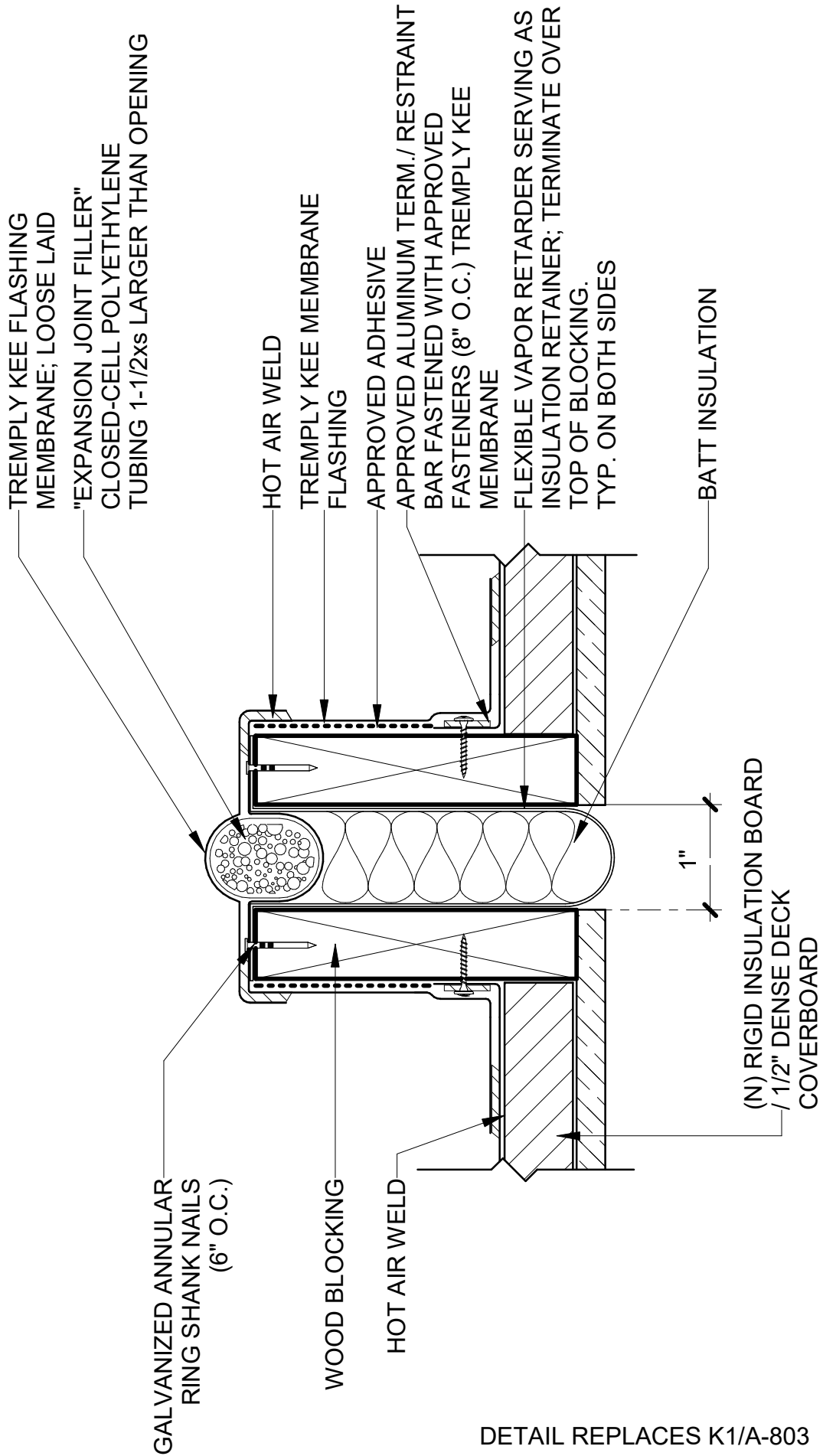

DETAIL REPLACES K1/A-803

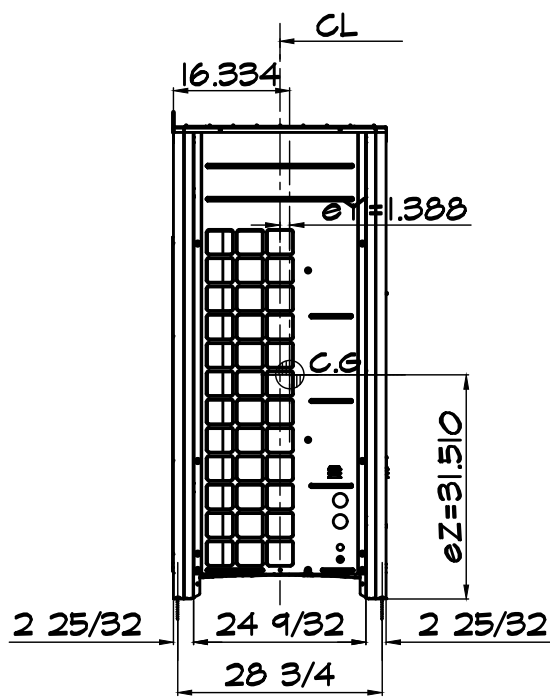

RIGHT SIDE VIEW

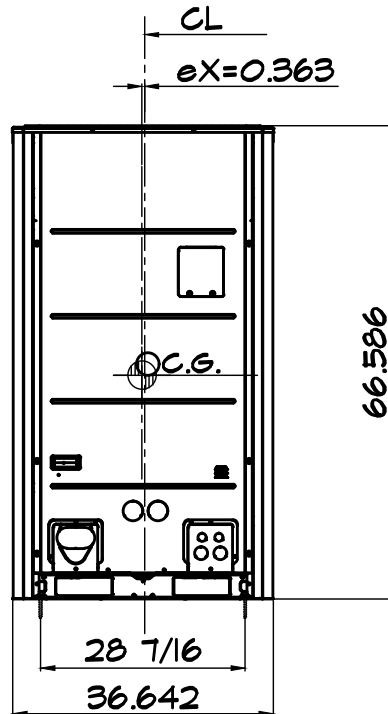

FRONT VIEW

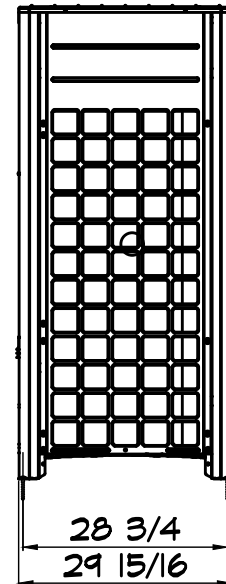

LEFT SIDE VIEW

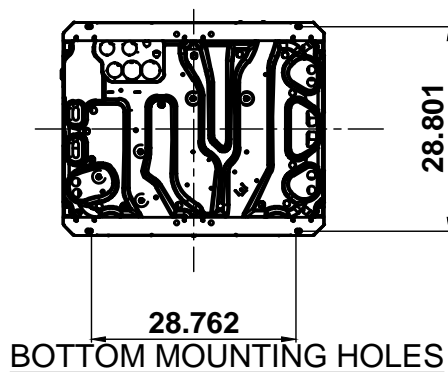

BOTTOM MOUNTING HOLES

1

# ODU 4 DIMENSIONS

TAG # ODU-4

SCALE: N.T.S.

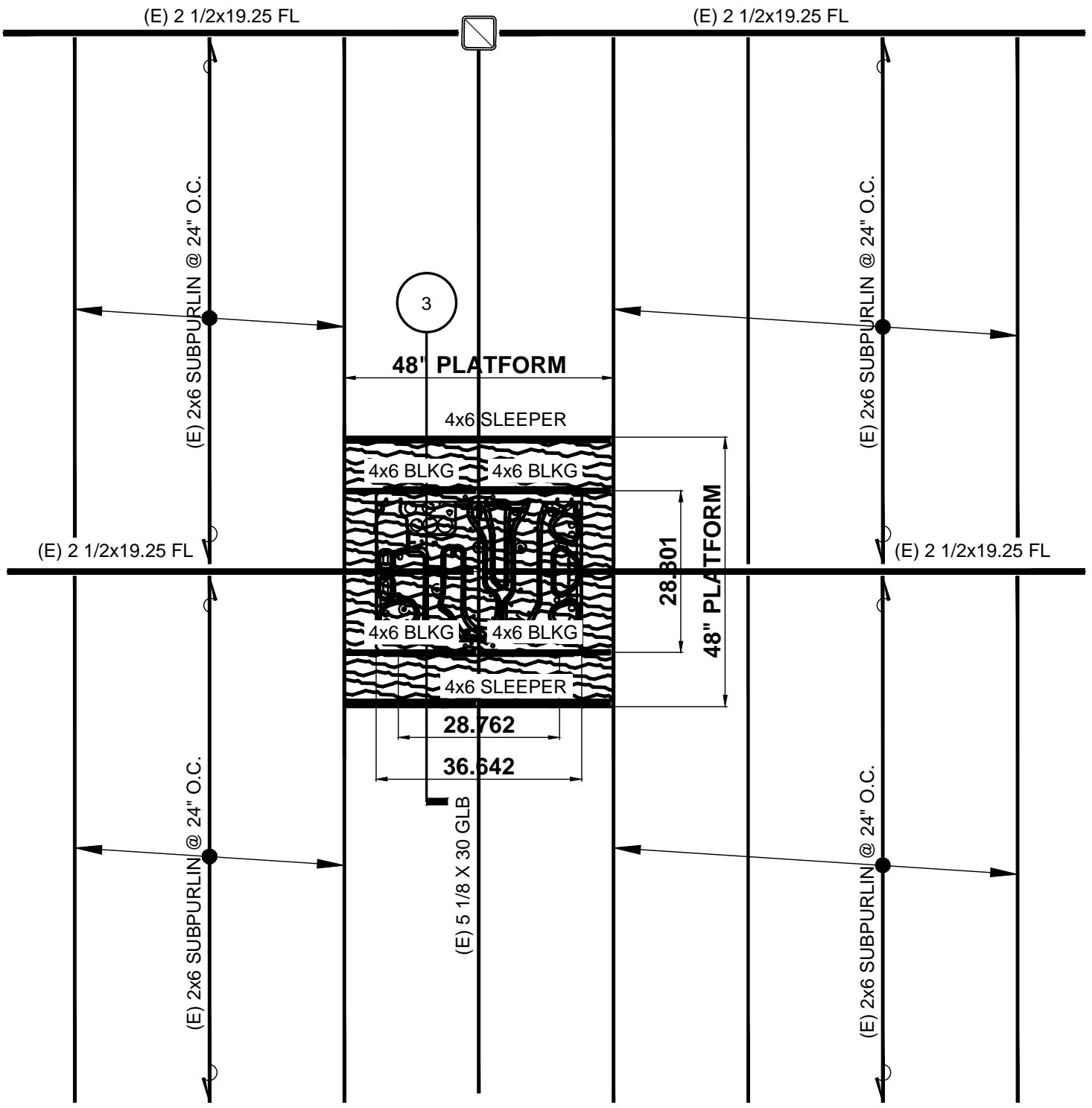

2

**ODU CURB FRAMING PLAN**

TAG # ODU-4

SCALE: N.T.S.

**NOTE:**  
REFER TO ARCH'L & MECH'L DWGS FOR  
EQUIP. CURB LOCATION & FINISHES.

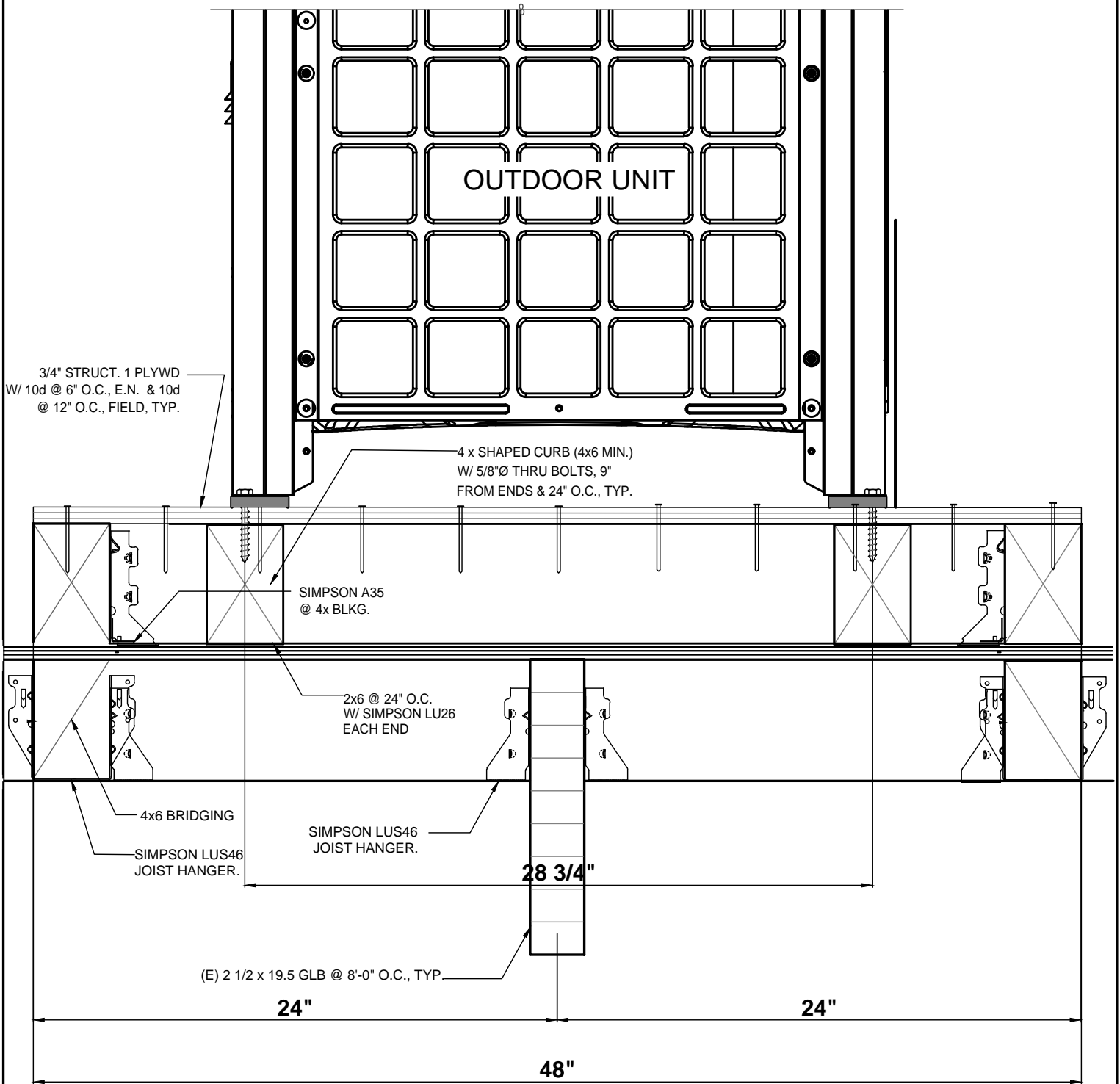

**3**

## **ODU CURB MOUNTING DETAIL**

SCALE: N.T.S.