

LAND DEPT  
ACQUIRE LAND RIGHTS

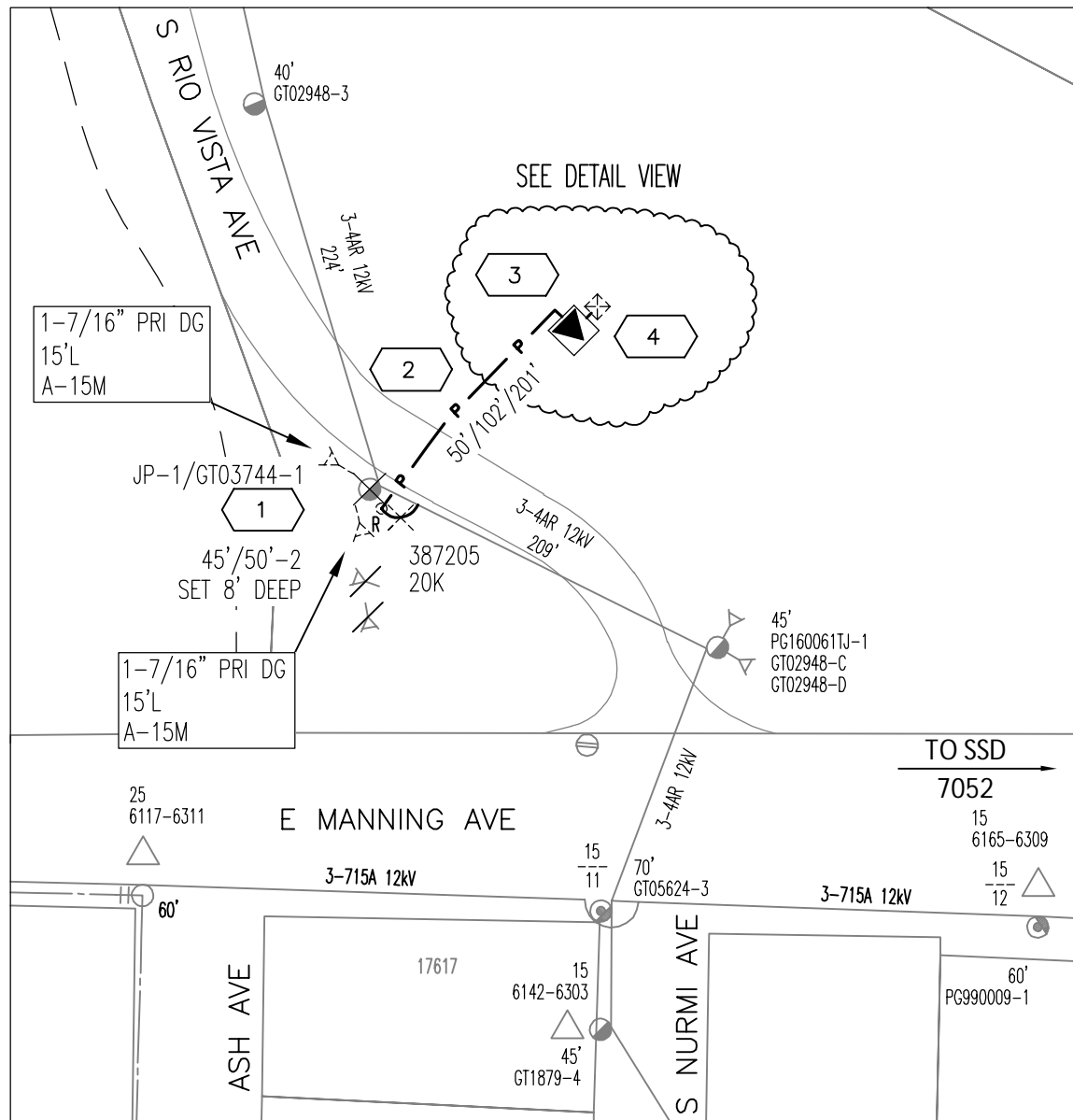
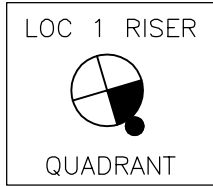

APPLICANT  
APPLICANT TO TRENCH, INSTALL ALL CONDUITS, SUBSTRUCTURES AND BACKFILL. MINIMUM TRENCH DEPTH SHOWN ON UG SPEC SHEET MAY BE USED FOR LENGTH OF SERVICE TRENCH, BUT MAY NEED TO BE ADJUSTED AT ENDS TO ACCOMMODATE SWEEPS, ENCLOSURES, RISERS AND PADS.

TELEPHONE  
JOINT MEET REQUESTED  
CONSTRUCTION FOREMAN TO CONTACT LOCAL TELEPHONE COMPANY 7 DAYS BEFORE DOING WORK FOR TRANSFER OF THEIR FACILITIES.

REQUIRED PERMITS  
 COUNTY  CITY  
 TRAFFIC CONTROL

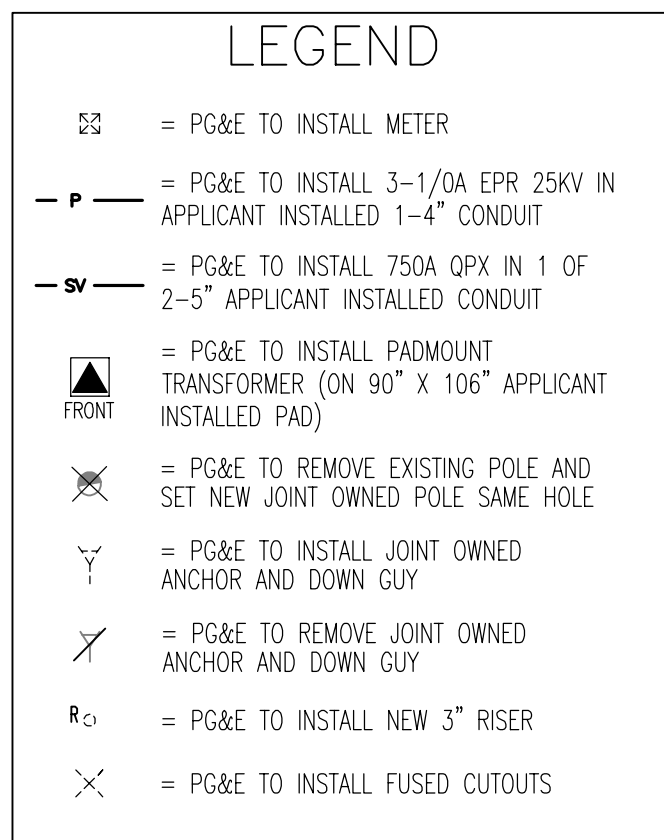
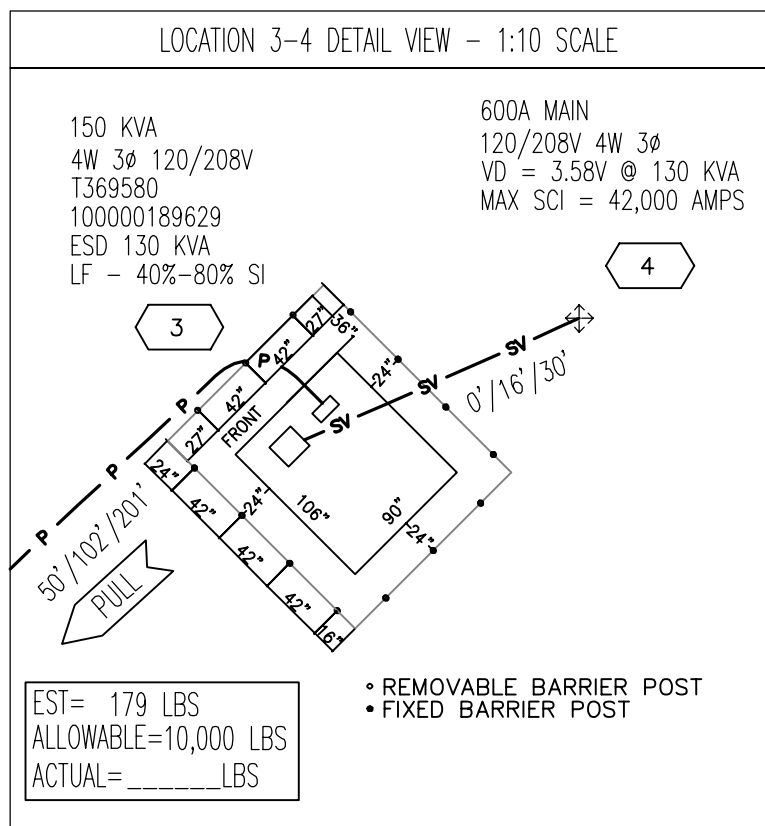

PRIMARY VOLTAGE: 12 kV	VOLTAGE AREA: 2
LATITUDE: 36.604460	LONGITUDE: -119.47214
SOURCE SIDE DEVICE: 7052	
SUB & CIRCUIT: WAHTOKE 1110	
DSGN SAG: LIGHT	RAPTOR ZONE: YES
LOADING AREA: LIGHT	ARRESTER DIST: 2
CORROSION AREA: NON	INSULATION DIST: C
EXEMPT EQUIP. INST.: N/A	FIRE AREA: LRA-TIER 1

CONSTRUCTION SKETCH  
17626 E MANNING AVE  
REEDLEY



GAS CONFLICT: NO

NEAR LOC: NONE

EST: LIAM JOHNSON	559-341-5305
ADE: TIMOTHY PETERSON	559-917-1108
SUPV: HENRY DIAZ	559-341-5283
REP: ALAN KOOBATIAN	559-347-5203
PLNR: HARPREET BASSI	559-326-6323
NOTIF: 126165463	JPA#: PG235114TT
SCALE: 1"=100'	DATE: 12/4/2023
PM: 35494147	SHEET: 1 OF 1 REV. 0