

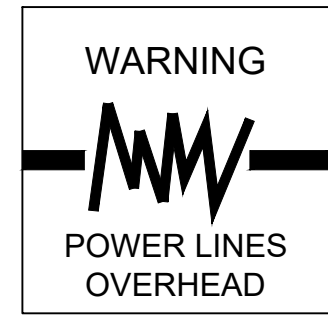

Know what's below.  
Call before you dig.



General area for clearing and grubbing of miscellaneous weeds, grass and vegetation.

Material removed during Clean and Grub operation can be spread on the western portion of the property.

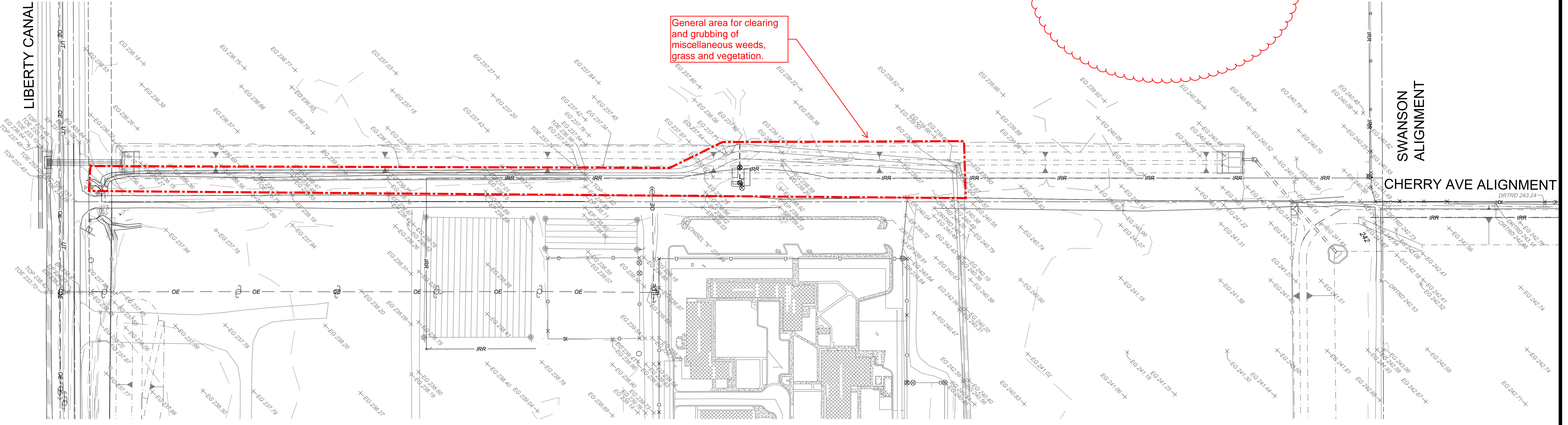

NOTE  
1. EXISTING SURVEY DATA WITH FUTURE IMPROVEMENTS SHOWN FOR REFERENCE.

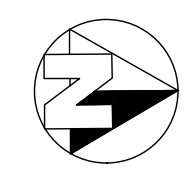

EST. 1968  
**PROVOST & PRITCHARD**  
CONSULTING GROUP  
An Employee Owned Company  
455 W FIR AVENUE  
CLOVIS, CALIFORNIA 93611-9166  
559/449-2700 FAX 559/449-2715  
https://provostandpritchard.com/

01/22/2024 10:28 AM g:\fresno\county\of\1597139722014-abborn\sch\basin\530 CAD\540 sheet\sheet01 CIVIL\G-4 EXISTING SITE PLAN CONVEYANCE CHANNEL AREA.dwg - Stephen Graze

DESIGNED: KJ	DATE: 8-29-2024	RECORD DRAWING: RESIDENT ENGINEER	SCALE: SCALE IN FEET			PROJECT: ELKHORN RECHARGE FACILITY		DEPARTMENT OF PUBLIC WORKS AND PLANNING		
DRAWN: SG	DATE: 8-29-2024	SCALE: 1" = 50'	PROJECT: HWY 41 & ELKHORN AVE, FRESNO COUNTY			EXISTING SITE PLAN				
CHECKED: KJ	DATE: 8-29-2024	SCALE: 1" = 50'	PROJECT: ROAD NO. BRIDGE NO.			CONVEYANCE CHANNEL AREA				
FOR RIGHT OF WAY DATA AND ACCURATE ACCESS DETERMINATION, SEE DOCUMENTS IN THE DEPARTMENT OF PUBLIC WORKS AND PLANNING.								DRAWING NO. 11330	SHEET NO. G-4	TOTAL 30



Know what's below.  
Call before you dig.

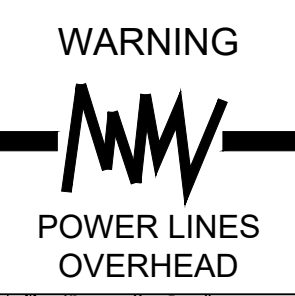

NOTE  
1. EXISTING SURVEY DATA WITH FUTURE IMPROVEMENTS SHOWN FOR REFERENCE.

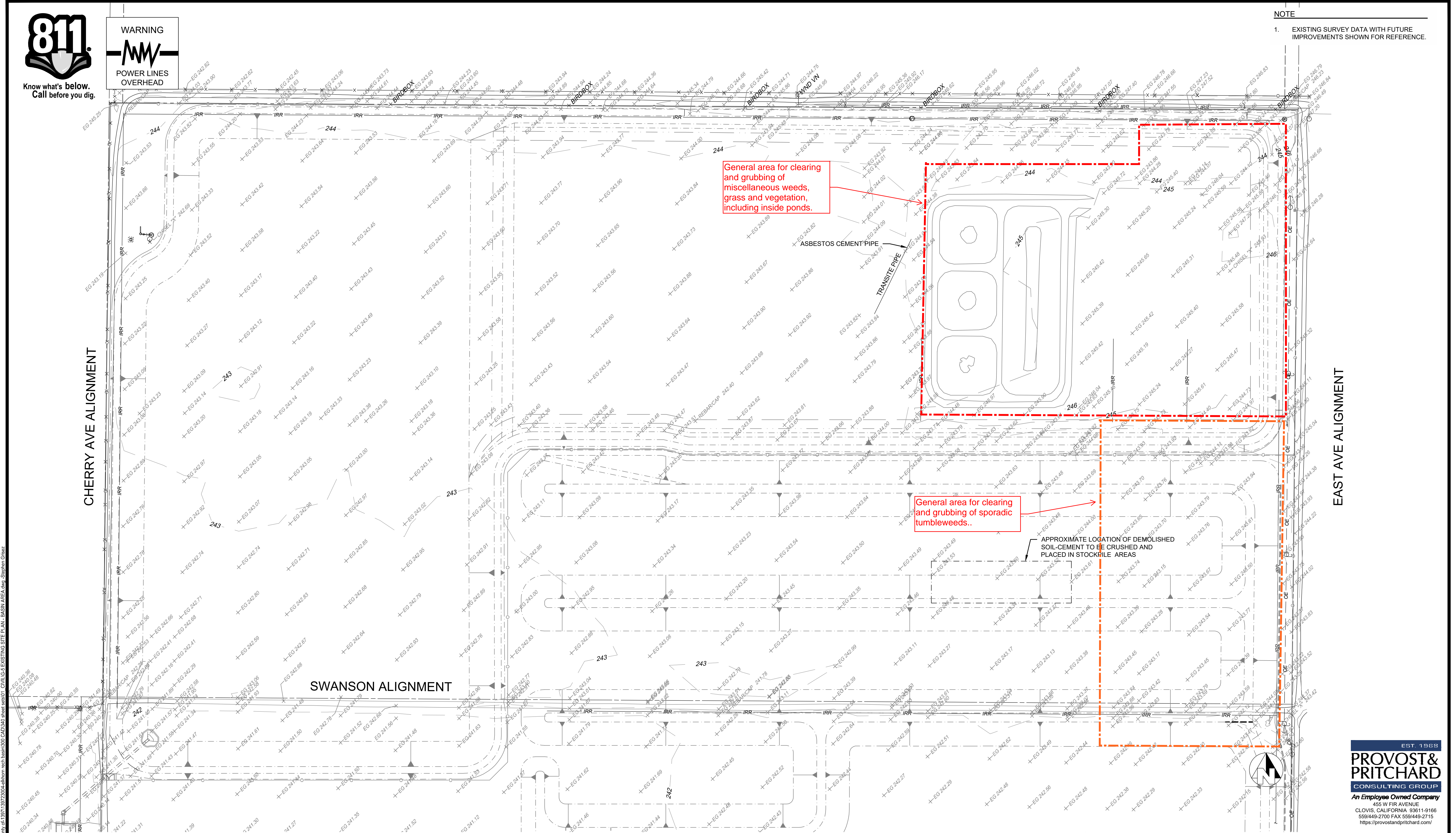

G:\172024\_1024\GIS\mxd\county\159715972024\aluminum\cherry\basin\30\CAD\240 sheet.dwg CIVIL G.S. EXISTING SITE PLAN - BASIN AREA.dwg - Stanham-Gleason

EAST AVE ALIGNMENT

CHERRY AVE ALIGNMENT

EST. 1968  
**PROVOST & PRITCHARD**  
CONSULTING GROUP  
An Employee Owned Company  
455 W FIR AVENUE  
CLOVIS, CALIFORNIA 93611-9166  
559/449-2700 FAX 559/449-2715  
https://provostandpritchard.com/

DESIGNED: KJ	DATE: 8-29-2024	RECORD DRAWING	
DRAWN: SG	DATE: 8-29-2024	RESIDENT ENGINEER	DATE
CHECKED: KJ	DATE: 8-29-2024		

FOR RIGHT OF WAY DATA AND ACCURATE ACCESS DETERMINATION, SEE DOCUMENTS IN THE DEPARTMENT OF PUBLIC WORKS AND PLANNING.

SCALE

SCALE IN FEET

SUPERVISING ENGINEER \_\_\_\_\_ DATE \_\_\_\_\_

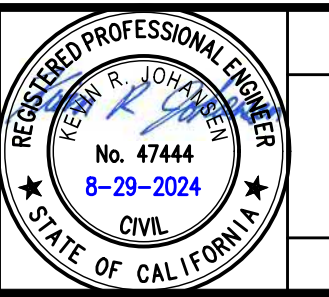

PROJECT  
**ELKHORN RECHARGE FACILITY**  
HWY 41 & ELKHORN AVE, FRESNO COUNTY

ROAD NO. \_\_\_\_\_ BRIDGE NO. \_\_\_\_\_



DEPARTMENT OF PUBLIC WORKS AND PLANNING

**EXISTING SITE PLAN - BASIN AREA**

DRAWING NO. 11330 SHEET NO. G-5 TOTAL 30